

FK-31059-000

SHT 1.1

NOTES:

- 1 A POSITIVE GOING VOLTAGE AT TERMINAL 2, RELATIVE TO TERMINAL 1, CAUSES A DECREASE IN PRESSURE AT THE SOUND OUTLET.
- 2 LOCATED FROM TWO SURFACES FOR CUSTOMER CONVENIENCE. ONLY APPLICABLE FROM ONE SURFACE, NOT TO BE USED TOGETHER.

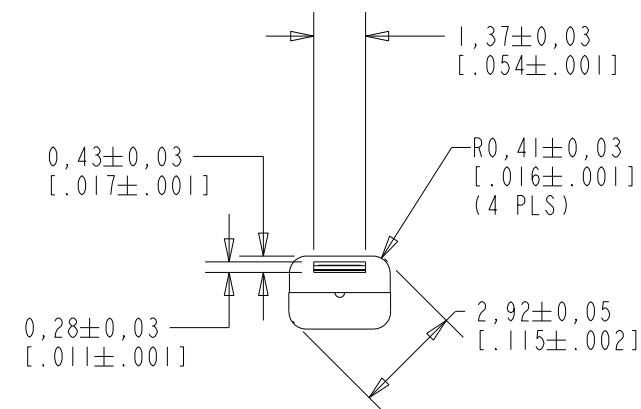
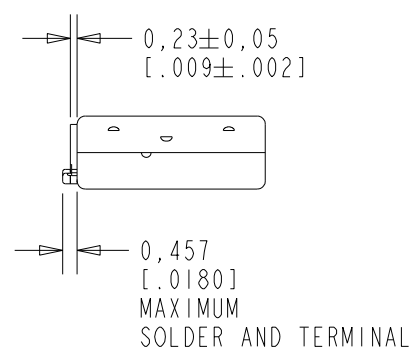
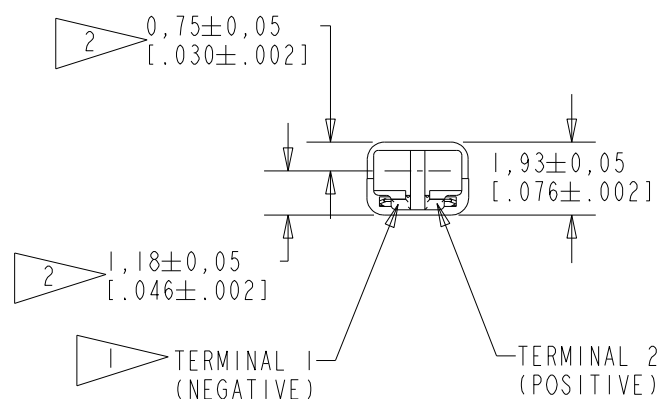
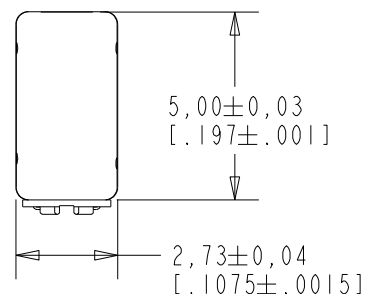

SCALE 2:1
NOMINAL WEIGHT
.11 GRAMS

DIMENSIONS IN MILLIMETERS [INCHES]

KNOWLES CORPORATION

Revision	C.O. #	Implementation Date	RELEASE LEVEL	REVISION
C	PI0000118	3-16-16	Active	C
B	CI0111046	3-5-10		
A	CI0110707	1-19-10		

SCALE:

5:1

DR. BY

DATE

LSY

1-19-10

CK. BY

DATE

GJP

1-22-10

APP. BY

DATE

GJP

1-22-10

TITLE:

RECEIVER

FK-31059-000

OUTLINE DRAWING

SHT 1.1

KE111ASIZE.FRM

Rev: B

THIS IS AN UNDAMPED MAGNETIC BALANCED ARMATURE RECEIVER INTENDED FOR USE IN CIC HEARING INSTRUMENTS.

NO DAMPING

FK-31059-000
SHEET 2.1

CONSTANT CURRENT DRIVE CONDITIONS

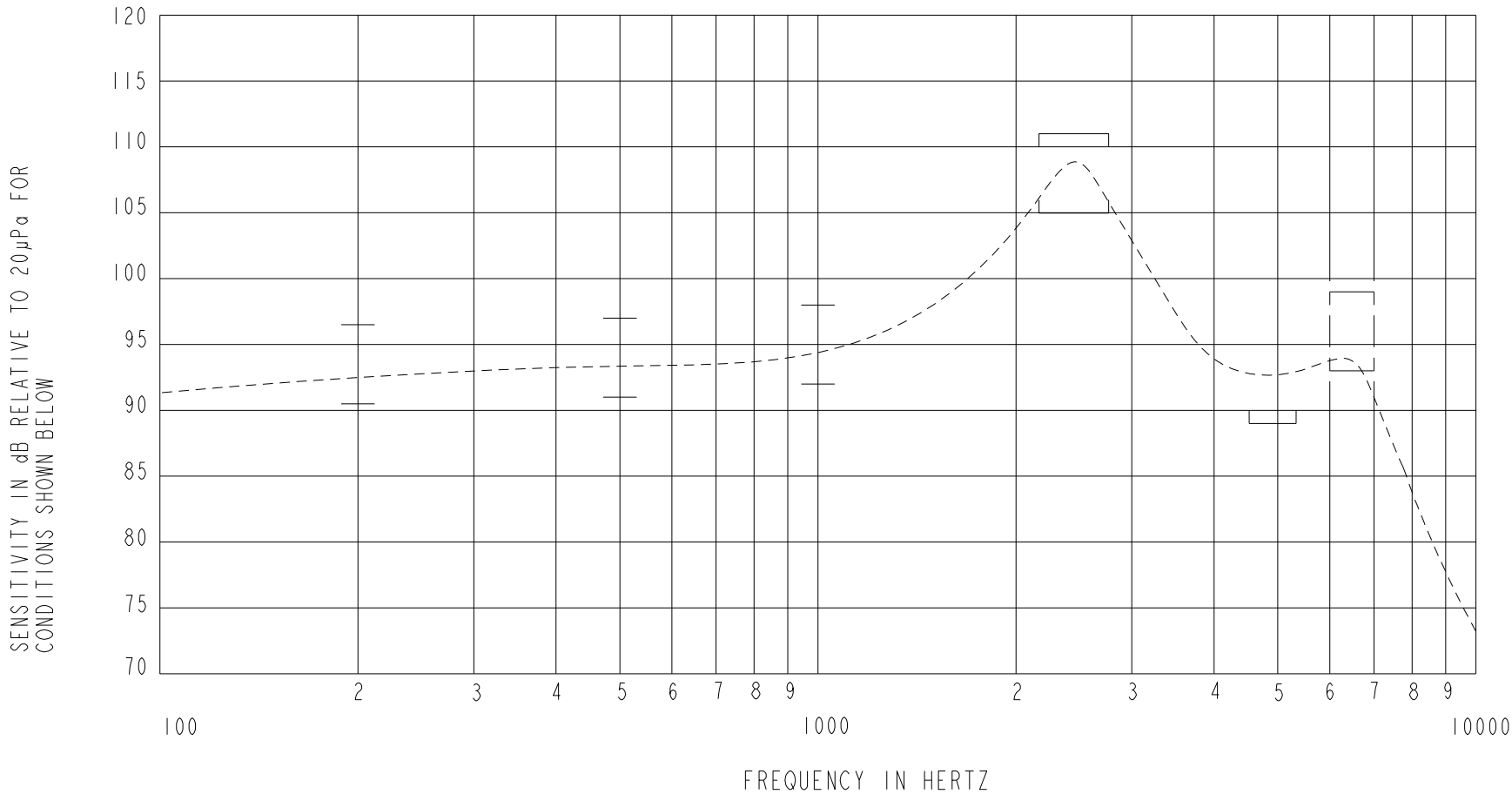

NOTES:

1. MEASUREMENTS MADE USING 10mm (.394") OF 1mm (.039") ID TUBE CONNECTED TO A SIMULATED ANSI S3.7 TYPE HA-3 (IEC 60318-5)

2.

FREQUENCY	MIN.	MAX.
200	90.5	96.5
500	91.0	97.0
1000	92.0	98.0
2200-2800	105.0	111.0
4550-5350	89.0	---
6000-7000	93.0	99.0

3. RESPONSE, IMPEDANCE, AND DISTORTION MEASUREMENTS MADE USING THE ELECTRICAL TEST CONDITIONS SHOWN BELOW.

4. ELECTRICAL SOURCE IMPEDANCE MUST BE GREATER THAN 20 TIMES 1kHz IMPEDANCE FOR TEST CONDITIONS SHOWN BELOW.

5. INDIVIDUAL SPECIFICATIONS.

PORT LOCATION	IMPEDANCE OHMS ±15%		DCR @20°C OHMS ±10%	DISTORTION		ELECTRICAL TEST CONDITIONS	
	1KHz	500Hz		MAX. %	FREQ Hz	AC mA RMS	DC mA
12N	313	234	200	5	800	0.77	0.00

6. ISOLATION: CASE WILL BE ELECTRICALLY ISOLATED FROM THE COIL CIRCUIT.

Revision	C.O. #	Implementation Date	RELEASE LEVEL		REVISION
C	PI0000118	3-16-16	Active		C
B	CI0111046	3-5-10			
A	CI0110707	1-19-10			
WHEN TEST LIMITS ARE USED TO ESTABLISH INCOMING INSPECTION ACCEPTANCE/REJECTION CRITERIA, CORRELATION OF TEST EQUIPMENT WITH KNOWLES IS ALSO REQUIRED FOR ELIMINATION OF EQUIPMENT AND TEST METHOD VARIATION			DR. BY	DATE	
			LSY	1-19-10	
			CK. BY	DATE	
			GJP	1-22-10	
TITLE: RECEIVER PERFORMANCE SPECIFICATION			FK-31059-000		
			SHT 2.1		
			APP. BY	DATE	
			GJP	1-22-10	

KNOWLES CORPORATION